



Project: Date:

Prepared by:

Comments:



FEATURES

- 5 Year Warranty
- Direct **60W** Incandescent Replacement
- **No Housing Required!!!**
- Energy Savings of up to 80%
- Lumen Maintenance over 70% @ 50,000+ Hours
- Compatible w/Most Triac Phase-Control Dimmers
- No UV/IR Radiation, No Toxic Mercury
- Die-Cast Aluminum Housing

OPTICS

- Magnetic Interchangeable Trim Rings Available
- Frosted White Lens
- Regressed Reflector
- Compatible with most 6" Housings

APPLICATIONS

- Ceiling Installations for General Ambient Lighting in Homes, Offices & Public Facilities
- Retail Store Lighting
- Museums, Galleries, Showrooms
- Hotels, Hospitality Areas
- Hospitals, Clinics, Workrooms
- Corridors, Lobbies, Stairways

CERTIFICATIONS

- cETLus Listed
- Energy Star Listed for Rebate and Tax Incentive Programs
- California Title 24 Compliant
- Rated for Wet-Locations / Airtight Rated

TRIM ORDERING OPTIONS

4" Easy-Up

MODEL NUMBER	KELVIN (CCT)	WATTS	LUMENS	CRI	TRIM COLOR
EV407941WH27	2700K	11.48	701	91	WHITE MAGNETIC
EV407941WH30	3000K	11.70	724	93	WHITE MAGNETIC
EV407941WH35	3500K	11.53	746	93	WHITE MAGNETIC
EV407941WH40	4000K	11.79	742	92	WHITE MAGNETIC
EV407941WH50	5000K	11.72	789	93	WHITE MAGNETIC

SPECIFICATIONS

Warranty	5 Years	Max. Ambient Temp:	45C	R-Value:	50	Beam Angel:	103 deg.
Expected Life	50,000 hrs	Min. Ambient Temp:	-18C	Power Factor:	>0.90	THD:	<20%





Project: Date:

Prepared by:

Comments:

DIMMING COMPATIBILITY

January 21, 2016 **6730M/6731A/6731F 120 V Triac or phase-cut dimmers**

Brand	Type	Series	Model #	Wiring	Version Code	Max # of Luminaires	Min # of Luminaires For Proper Dimming	Dimming Range	
Lutron	C.L	Ariadni/Toggler C.L	AYCL-153P	3-Way	T4, T8	14	1	3% - 96%	
			TGCL-153P						
		Diva C.L							
		DVCL-153P							
		SkyLark C.L							
		SCL-153P							
	Skylark Contour C.L	CTCL-153P							
		LGCL-153P							
	Wireless	Grafik T RF	GTI 150	MACL-153M	3-Way	2014	14	1	5% - 96%
				MSCl-VP153M	single/multi	T2	14	1	4% - 96%
MSCl-OP153M				single/multi					
MRF2-6CL				NA	M6	14	1	4% - 96%	
Nova T				NTCL-250	single	BR Y02	24	1	4% - 97%
Grafik T				GT-150	single	T6	14	1	4% - 97%
Leviton	Universal Dimmer	Sureslide	6672-1L	3-Way	NA	14	1	5% - 97%	
			6674-P0	3-Way	NA	14	1	5% - 97%	
			Caseta	PD-6WCL	NA	SD11	14	1	2% - 96%
			Decora	DSL06-1L	3-Way	NA	29	1	21% - 97%
			Illuma Tech	IPL06-10	3-Way	NA	14	1	5% - 97%
			Sureslide	6672-1L	single	NA	14	1	8% - 97%

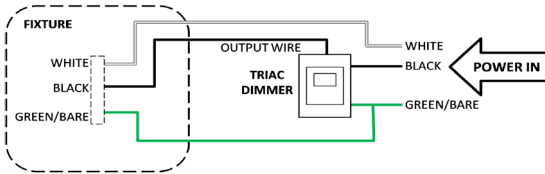

DIMENSIONS

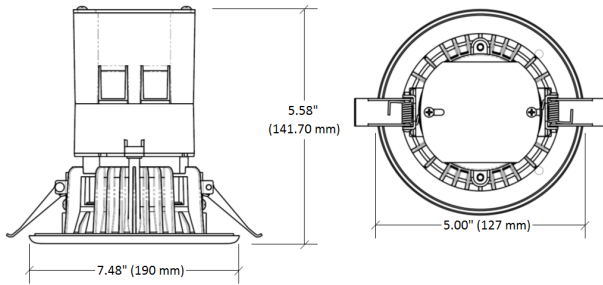

PHOTOMETRICS

MANUFACTURER: NEW EARTH LIGHTING, INC.
 TEST LAB: BEST TEST SERVICE SHENZHEN CO; LTD
 TEST DATE: 2014-04-17
 DESCRIPTION: K9Y4WHWH2C27
 LAMP: K9Y4WHWH2C27
 LAMP OUTPUT: 1 LAMP, RATED LUMENS/LAMP: 701.9
 INPUT WATTAGE: 11.5
 LUMINOUS OPENING: CIRCULAR (DIA: 3.54")
 MAX CD: 321.1 AT HORIZONTAL: 157.5°, VERTICAL: 1°
 CUTOFF CLASS: CUTOFF
 ROADWAY CLASS: TYPE VS
 EFFICIENCY: 100%

No
Photo
Available

ZONAL LUMEN SUMMARY

ZONE	LUMENS	% LAMP	% LUMINAIRE
0-30	244.1	34.8%	34.8%
0-40	388.2	55.3%	55.3%
0-60	614.1	87.5%	87.5%
60-90	85.8	12.2%	12.2%
70-100	29.4	4.2%	4.2%
90-120	0.6	0.1%	0.1%
0-90	699.9	99.7%	99.7%
90-180	1.9	0.3%	0.3%
0-180	701.8	100%	100%

LUMENS PER ZONE

ZONE	LUMENS	% TOTAL	ZONE	LUMENS	% TOTAL
0-10	30.3	4.3%	90-100	0.1	0%
10-20	86.2	12.3%	100-110	0.2	0%
20-30	127.6	18.2%	110-120	0.2	0%
30-40	144.1	20.5%	120-130	0.3	0%
40-50	130.3	18.6%	130-140	0.3	0%
50-60	95.7	13.6%	140-150	0.3	0%
60-70	56.6	8.1%	150-160	0.2	0%
70-80	24.4	3.5%	160-170	0.2	0%
80-90	4.9	0.7%	170-180	0.0	0%

